

TOTAL

One-Stop Tools Station

INDUSTRIAL

**BENZINA
TAGLIA ERBA**

MANUALE DEL PRODOTTO

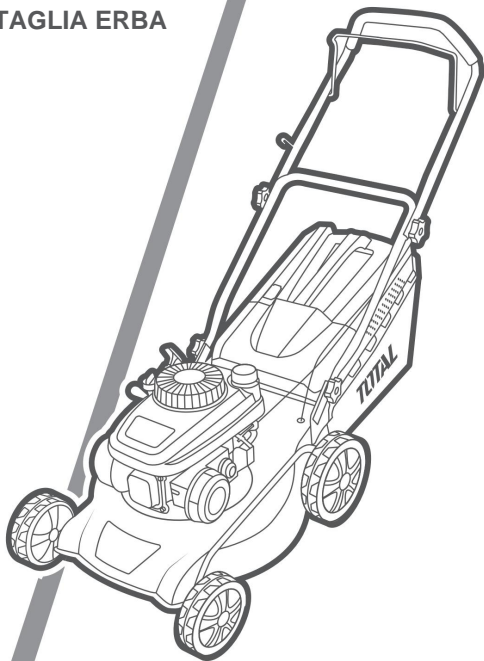

TGT141181



Original Instructions

GENERAL SAFETY WARNINGS**Training**

- a) **Read the instructions carefully.** Be familiar with the controls and the proper use of the equipment.
- b) **Never allow children or people unfamiliar with these instructions to use the lawnmower.** Local regulations can restrict the age of the operator.
- c) **Never mow while people, especially children, or pets are nearby.**
- d) **Keep in mind that the operator or user is responsible for accidents or hazards occurring to other people or their property.**

Preparation

- a) **While mowing, always wear substantial footwear and long trousers.** Do not operate the equipment when barefoot or wearing open sandals.
- b) **Thoroughly inspect the area where the equipment is to be used and remove all objects which can be thrown by the machine.**

 WARNING!

- c) **Petrol is highly flammable:**
 - Store fuel in containers specifically designed for this purpose;
 - Refuel outdoors only and do not smoke while refueling;
 - Add fuel before starting the engine. Never remove the cap of the fuel tank or add petrol while the engine is running or when the engine is hot;
 - If petrol is spilled, do not attempt to start the engine but move the machine away from the area of
 - Spillage and avoid creating any source of ignition until petrol vapors have dissipated;
 - Replace all fuel tank and container caps securely.
- d) **Replace faulty silencers.**
- e) **Before using, always visually inspect to see that the blades, blade bolts and cutter assembly are not worn or damaged.** Replace worn or damaged blades and bolts in sets to preserve balance.
- f) **On multi-bladed machines, take care as rotating one blade can cause other blades to rotate.**

Operation













- a) **Do not operate the engine in a confined space where dangerous carbon monoxide fumes can call.**
- b) **Mow only in daylight or in good artificial light.**
- c) **Avoid operating the equipment in wet grass, where feasible. Always be sure of your footing on slopes.**
- d) **Walk, never run.**
- e) **For wheeled rotary machines, mow across the face of slopes, never up and down.**
- f) **Exercise extreme caution when changing direction on slopes.**
- g) **Do not mow excessively steep slopes.**
- h) **Use extreme caution when reversing or pulling the lawnmower towards you.**
- i) **Stop the blade(s) if the lawnmower has to be tilted for transportation when crossing surfaces other than grass, and when transporting the lawnmower to and from the area to be mowed.**
- j) **Never operate the lawnmower with defective guards, or without safety devices, for example defectors and/or grass catchers, in place.**
- k) **Do not change the engine governor settings or over speed the engine.**
- l) **Disengage all blades and drive clutches before starting the engine.**
- m) **Start the engine or switch on the motor carefully according to instructions and with feet well away from the blade(s).**
- n) **Do not tilt the lawnmower when starting the engine or switching on the motor, except if the lawnmower has to be tilted for starting. In this case, do not tilt it more than absolutely necessary and lift only the part which is away from the operator.**
- o) **Do not start the engine when standing in front of the discharge chute.**
- p) **Do not put hands or feet near or under rotating parts. Keep clear of the discharge opening at all times.**
- q) **Never pick up or carry a lawnmower while the engine is running.**
- r) **Stop the engine and disconnect the spark plug wire, make sure that all moving parts have come to a complete stop and, where a key is fitted remove the key:**
 - Before clearing blockages or unclogging chute;
 - Before checking, cleaning or working on the lawnmower;

- After striking a foreign object. Inspect the lawnmower for damage and make repairs before restarting and operating the lawnmower;
 - If lawnmower starts to vibrate abnormally (check immediately).
- s) **Stop the engine and disconnect the spark plug wire, make sure that all moving parts have come to a complete stop and, where a key is fitted remove the key:**
- Whenever you leave the lawnmower;
 - Before refueling.
- t) **Reduce the throttle setting during engine shut down and, if the engine is provided with a shut-off valve, turn the fuel off at the conclusion of mowing.**
- u) **Go slow when using a trailing seat.**

Maintenance and storage

- a) **Keep all nuts, bolts and screws tight to be sure the equipment is in safe working condition.**
- b) **Never store the equipment with petrol in the tank inside a building where fumes can reach an open flame or spark.**
- c) **Allow the engine to cool before storing in any enclosure.**
- d) **To reduce the fire hazard, keep the engine, silencer, battery compartment and petrol storage area free of grass, leaves, or excessive grease.**
- e) **Check the grass catcher frequently for wear or deterioration.**
- f) **Replace worn or damaged parts for safety.**
- g) **If the fuel tank has to be drained; this should be done outdoors.**

THE SYMBOLS IN INSTRUCTION MANUAL

	Read the instruction manual before using.
	CE conformity.
	Safety alert. Please only use the accessories supported by the manufacturer.
	Wear safety glasses, hearing protection and dust mask.
	Waste electrical products should not be disposed of with household waste. Please recycle where facilities exist. Check with your Local Authority or retailer for recycling advice.
	Take care when handling fuel and lubricants
	The lawnmower exhaust gases contain poisonous substances. Do not run the engine in closed or poorly ventilated areas.
	Do not attempt to clear grass from the rear chute area while the blade is still rotating. The exhaust and other parts of the engine will get very hot during use, do not touch.
	Remove the ignition cable before all maintenance work, and read the instructions for use.
	Wear robust footwear when using the device.
	Wear protective gloves when using the device.
	Keep other people out of the dangerous area.

ADDITIONAL SAFETY WARNING

Even if you use this tool correctly, there are always residual risks. The following hazards may arise in connection with the structure and manufacture of this power tool:

- a) Hearing impairment if no suitable hearing protection is worn.
- b) Cuts if no suitable protective clothing is worn.
- c) Health damage resulting from vibration in the hands and arms if the device is used for a long period of time or is not handled and maintained properly.
- d) Inhalation of particles
- e) Inhalation of exhaust gases
- f) Skin contacts with oil/gasoline
- g) Inhalation of gasoline/oil vapors
- h) Contact with projected objects
- i) Burns when touching with hot surfaces
- j) Prolonged use of this product exposes the operator to vibration and can produce so-called "white finger" disease. To reduce the risk, wear gloves and keep your hands warm.
- k) If any of the symptoms of "white finger syndrome" occur, seek immediately medical attention. Symptoms of the "white finger" include numbness, loss of sensitivity, tingling, pain, loss of strength, color changes or skin condition. These symptoms usually appear on the fingers, hands or wrists. Risk increases at low temperatures.

INTENDED USE

This lawn mower has been designed for cutting grass. Any other use is not permitted.

The lawn mower is suitable for private use in the garden only, lawn mowers for private use are those which are used for cutting grass and lawns in the garden, however not for cutting grass in public parks, playing fields or on farms or in forest.

Persons who are not familiar with the operating manual, children, young people under the age of 16 as well as persons under the influence of alcohol, drugs or medication must not operate the unit.

While it is permitted to use a lawn mower at any time, operators should always show due consideration to others living nearby.

SPECIFICATIONS

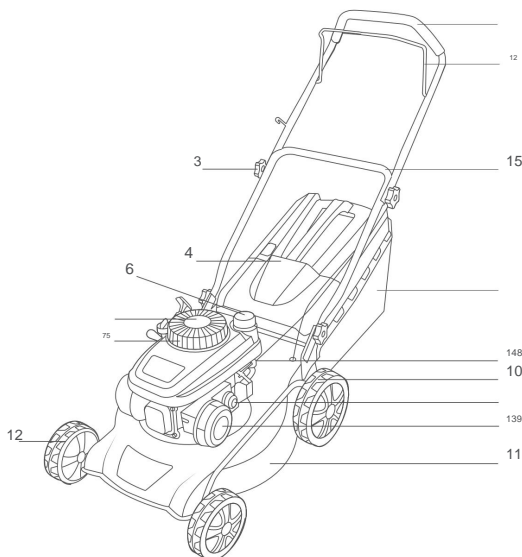

- | | |
|----------------------------|-----------------------|
| 1. Upper handle | 9. Spark |
| 2. Starting bail arm lever | 10. Front wheel |
| 3. Wing nut | 11. Housing |
| 4. Rear cover | 12. Rear wheel |
| 5. Recoil starter handle | 13. Handle increased |
| 6. Petrol tank cap | 14. Grass catcher bag |
| 7. Engine | 15. Lower handle |
| 8. Oil filling bolt | |

Technical specifications

Model No.	TGT141181
Engine displacement	141cm ³
Engine max. motor power	3.0kW
Equipment mobility	Hand push
Volumes of fuel tank	0,9 l
Volumes of lubricating oil tank	0,5 l
Cutting width	460mm
Rated speed	2600/min
Net weight (including engine)	22. 4kg
Sound power level	96 dB(A)
Vibrations	2.76 m/s ² k =1.5 m/s ²
Adjustable height	25-70 mm/7channel

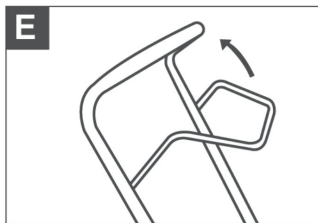
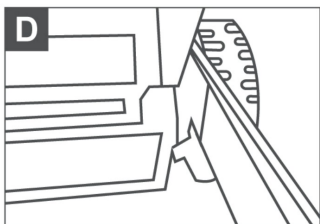
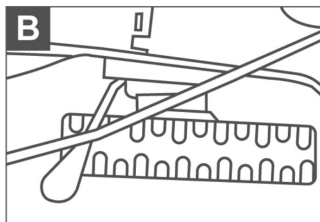
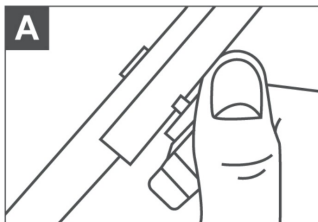
OPERATION PICTURE

OPERATION

When assembling this machine, please follow the instructions for assembly printed.

First, release bolts, and then fit the lower handle on the brackets, last ensure bolts that it does tighten enough.

Note

The bolt should be fixed as below photo and on both sides.

Connect the throttle wire and self-propelled wire on Bail arm lever. Take the wire head into the hole of starting bail arm lever. Ensure the wire won't be loose

Fit the Upper handle to lower handle. (see Figure A)

Release two wing nuts on lower handle, as below picture, and then fit the upper handle on lower handle. Ensure the wing nuts are tightened enough.

There are 7 working positions for each wheel, adjust the handle according to below picture. (see Figure B)

Attaching and removing the grass catcher. (see Figure C&D)

Figure C: Lift the rear cover and tighten the grass catcher bag on the back of the mower.

Figure D: Lift the rear cover and remove the grass catcher bag.

Starting a cold engine. (see Figure E)

1. The Throttle Cable assy, located on the right-hand side of the upper handle, is used to regulate the engine speed.
2. Press 3 times in hot weather or 5/6 times a very cold time the red primer on the front left side of the air filter.
3. Attach the spark plug ensuring the metal cap is fastened securely to the metal tip on the spark plug.
4. The flywheel brake lever / operator presence control / OPC handle is located in the upper handle of the lawnmower. The handle must be depressed to allow the ignition and held against the upper handle.
5. The recoil starter handle is attached to the upper handle on the right-hand side. When starting, always stand behind the lawnmower in the operating position. Pull the recoil starter handle until the engine runs.

6. Once started, allow 2 / 3 minutes for the engine to warm up before mowing.

The blade starts to rotate after the engine is switched on.

Starting a warmed-up engine.

Depress the OPC handle to allow the ignition and held against the upper handle.

Pull the recoil starter handle until the engine runs.

WARNING!

The blade continues to rotate after the engine is switched off.

WARNING!

The OPC handle is a safety device.

Never attempt to bypass its operations. The blade will be rotating when the engine is running.

MAINTENANCE&MALFUNCTIONS

Possible malfunctions and methods of their eliminations

Engine will not start	Possible cause	Correction
Electric starting	Battery discharged	Recharge battery
Check battery		
Check control positions	Fuel switch OFF	Turn fuel switch to ON
	Engine switch OFF	Turn engine switch to ON
Check fuel	Out of fuel	refuel
	Bad fuel; engine stored without treating or draining gasoline, or refueled with bad gasoline	Drain fuel tank and carburetor, refuel with fresh gasoline
Engine will not start	Possible cause	Correction
Remove and inspect sparkplugs	Spark plugs faulty, fouled or improperly gapped	Gap or replace spark plugs
	Spark plugs wet with fuel (flooded engine)	Dry and reinstall sparkplugs
Take engine to an authorized servicing dealer, or refer to manual	Fuel filter clogged, Carburetor malfunction, ignition malfunction, etc.	Replace or repair faulty components as necessary
Engine lacks power	Possible cause	Correction
Check air filter	Filter element(s) clogged	Clean or replace filter element(s)
Check fuel	Bad fuel; engine stored without treating or draining gasoline, or refueled with bad gasoline	Drain fuel tank and carburetor, refuel with fresh gasoline
Take engine to an authorized servicing dealer, or refer to manual	Fuel filter clogged, Carburetor malfunction, ignition malfunction, etc.	Replace or repair faulty components as necessary

Note: The engine installation and major repair work shall be carried out only by specifically trained personnel.

TOTAL

One-Stop Tools Station

www.totalbusiness.com



MADE IN CHINA T1024.V08



NEWWAY TECHNOLOGY (SUZHOU) CO., LIMITED No.20

Dagang Road, Fuqiao Town, Taicang City, Cina

